



重 慶 三 等 重 慶 有 限 公 司  
 華 街 6 9 號

TEL : 02-28577979 FAX : 02-28579292

Type H

Type Z

Type F

Type C

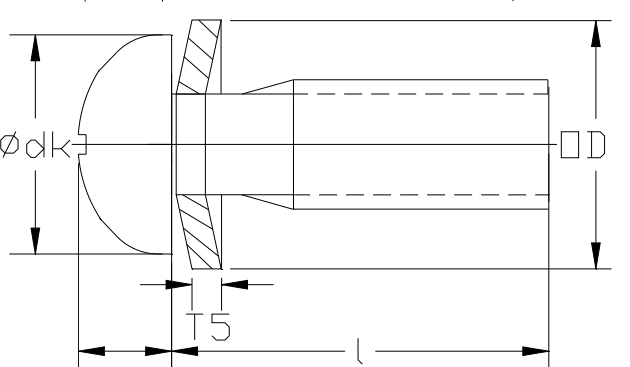
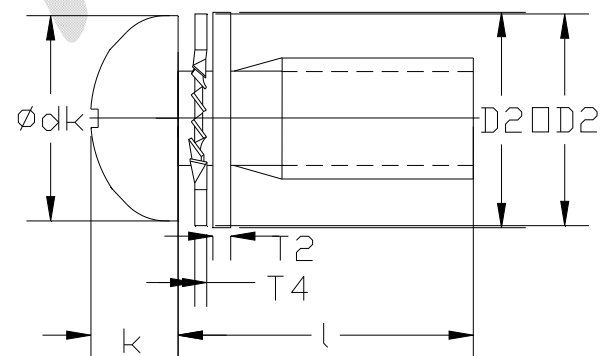
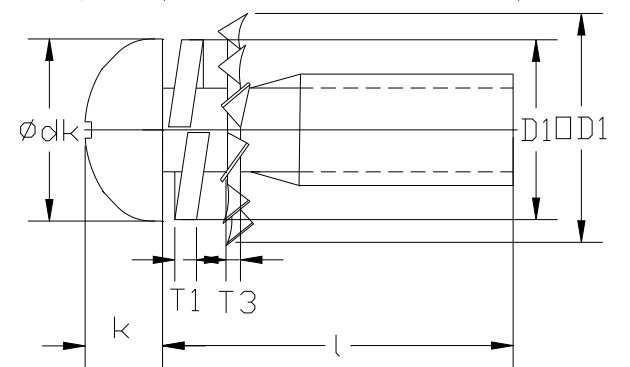
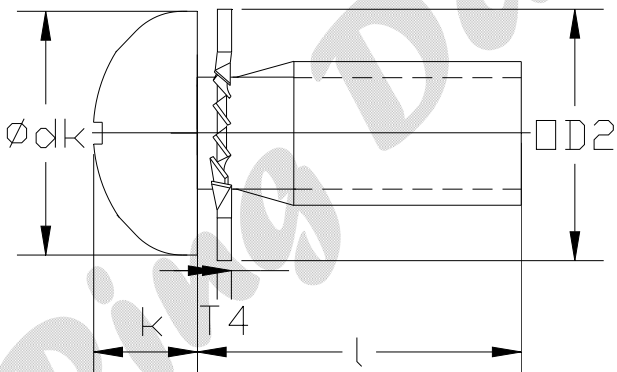
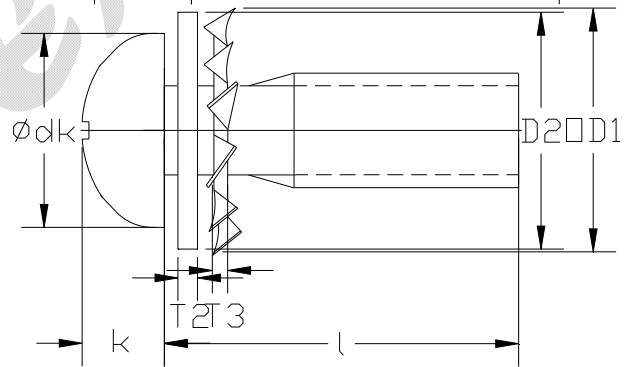
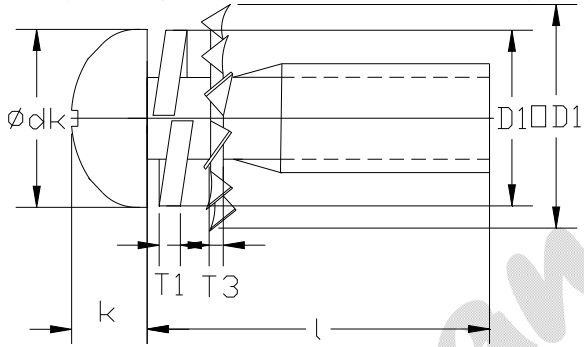
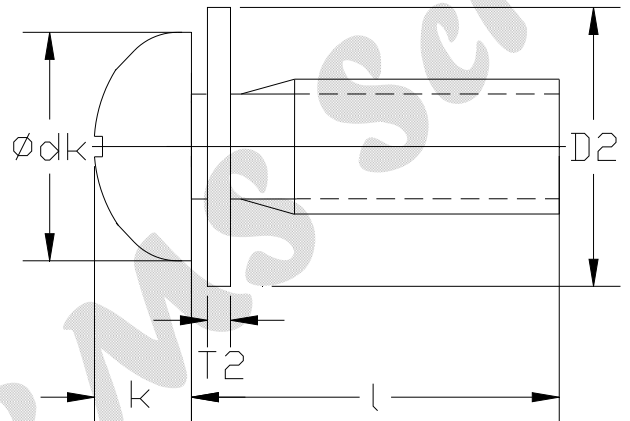
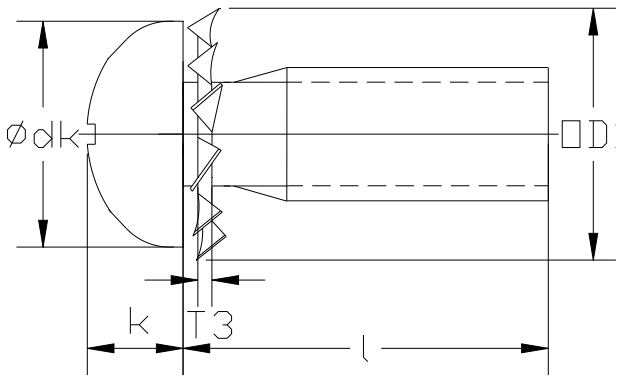
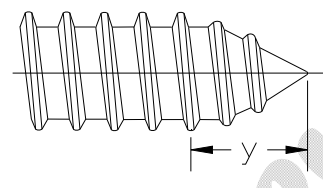
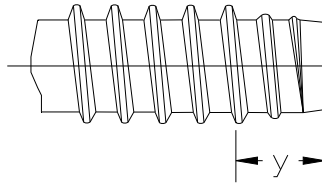
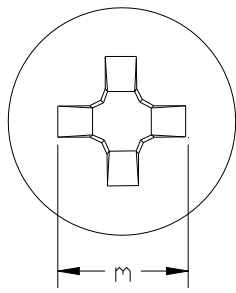
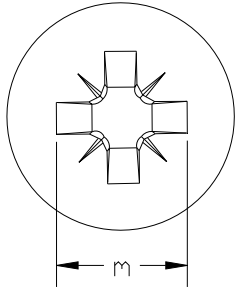

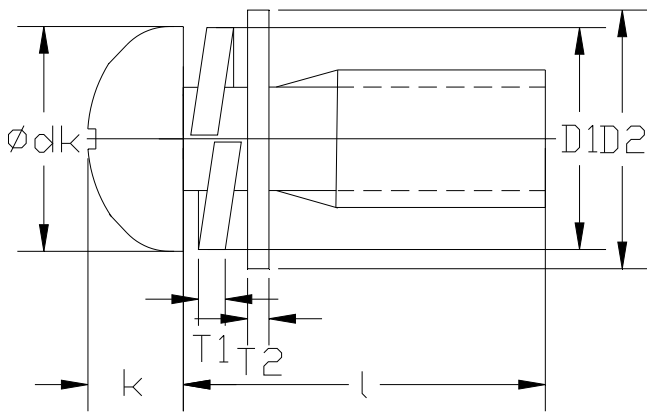

(d)		ST 2.2	ST 2.9	ST 3.5	ST 4.2	ST 4.8	ST 5.5	ST 6.3	
$d_k$	max.	4	5.6	7	8	9.5	11	12	
	min.	3.7	5.3	6.64	7.64	9.14	10.57	11.57	
$k$	max.	1.6	2.4	2.6	3.1	3.7	4	4.6	
	min.	1.4	2.15	2.35	2.8	3.4	3.7	4.3	
Cross recess	Type H Penetration	m ref.	1.9	3	3.9	4.4	4.9	6.4	6.9
		min.	0.85	1.4	1.4	1.9	2.4	2.6	3.1
	max.	1.2	1.8	1.9	2.4	2.9	3.1	3.6	
	Type Z Penetration	m ref.	2	3	4	4.4	4.8	6.2	6.8
		min.	0.95	1.45	1.5	1.95	2.3	2.55	3.05
	max.	1.2	1.75	1.9	2.35	2.75	3	3.5	
y ref.	Type C	2	2.6	3.2	3.7	4.3	5	6	
	Type F	1.3	2.1	2.5	2.8	3.2	3.6	3.6	

附註：

1. 參考 DIN 7981
2. V 型外齒參考 DIN 6797